

Scott Grove

BY CONRAD

**Townhomes designed
for every moment
in time.**

2 SCOTT GROVE
GLEN IRIS



**“While completely contemporary,
Scott Grove echoes the stature of Victorian
architecture. Confident proportions, a sense
of substance and restraint create enduring
elegance. Its sophistication rests easily in the
surrounding canopy of green.”**

PAUL CONRAD

ARTISTS IMPRESSION
EXTERIOR - SUNRISE



2 SCOTT GROVE

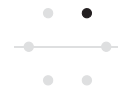

Morning light is welcomed, softly starting the day. Greenery is glimpsed through expansive glass, the calm heightened by restrained elegance and space.

Luxuriously serene, it's the first of the special moments to come.

ARTISTS IMPRESSION
BEDROOM - SUNRISE

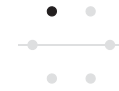
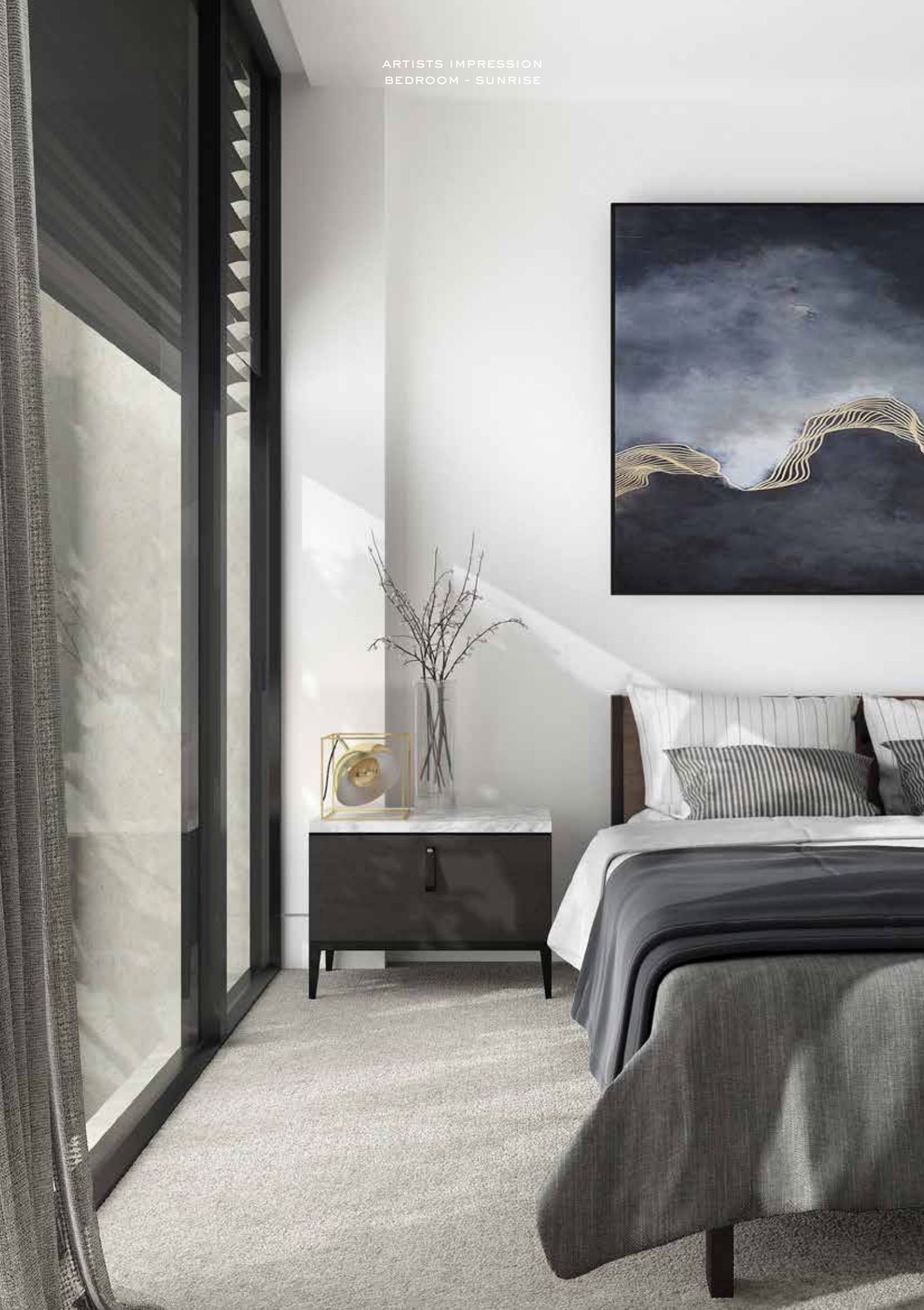

A moment of tranquility.

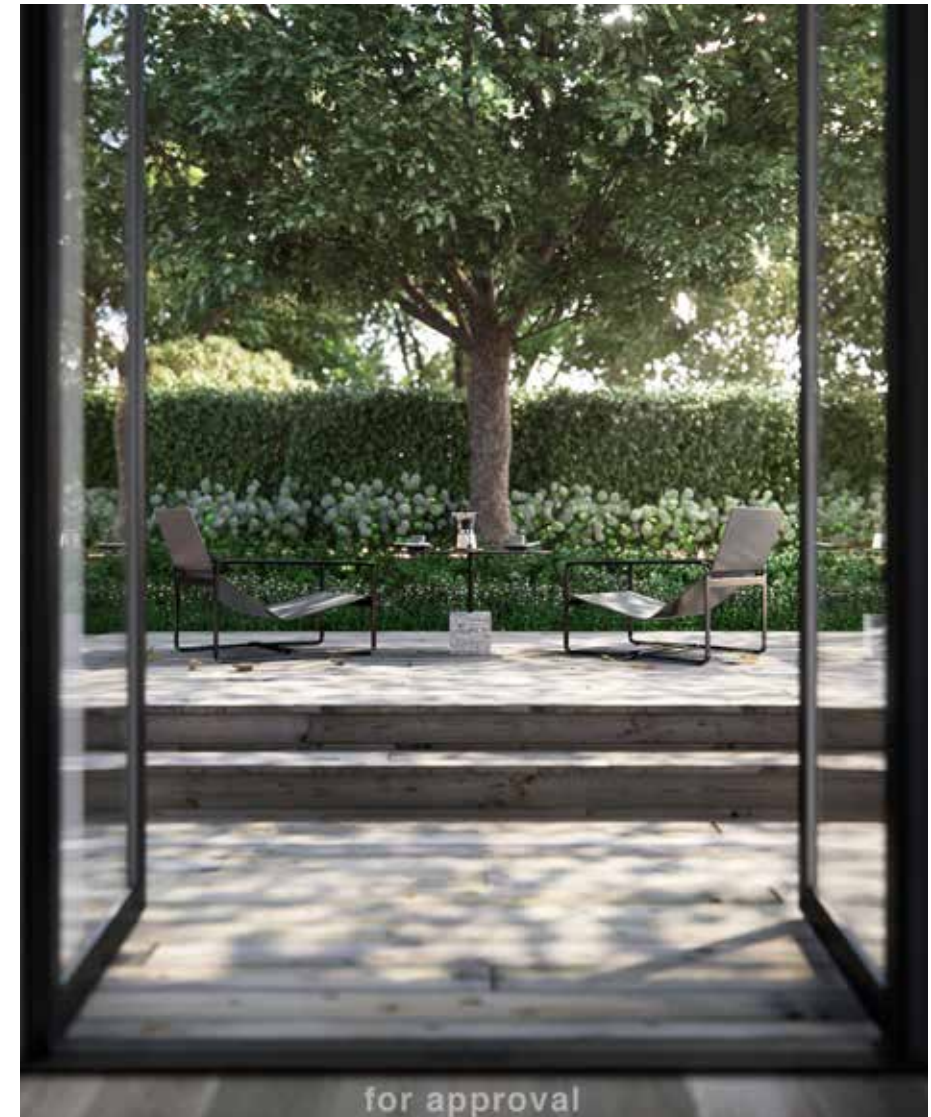

Floor to ceiling glazing floods interiors with natural light. Thoughtfully designed gardens complement leafy surrounds and vine-adorned pergolas enhance tranquil courtyards.



Each day unfolds to find contemporary ease and subtle sophistication. Enjoyment moves seamlessly between beautifully crafted, light-filled interiors and outdoor spaces of natural calm. Comfort and a sense of grace lend every moment timeless style.

ARTISTS IMPRESSION
LIVING - AFTERNOON



A moment of style



Lorem ipsum dolor sit amet, consectetur adipiscing.
Proin interdum turpis suscipit, tincidunt sem ac, cursus
Curabitur tempor odio velit, ac convallis mi dignissim
sit amet. Donec id eleifend turpis.







Precious time with loved ones deserves a special home. Generous indoor and outdoor spaces interact effortlessly with each other. Thoughtful comforts inspire wellbeing while luxury invites celebration. The stage is set for memorable moments to be shared.

ARTISTS IMPRESSION
KITCHEN - EVENING



A moment to share



Spacious kitchens integrate high-grade Gaggenau appliances including fridge/freezer and dual ovens. Marble benches set off functionality with classical elegance.





Key

- 01. Central Park / John Landy Oval
- 02. Malvern East retail
- 03. Street Organics
- 04. Gardiner Train Station
- 05. Sacre Cour Girls School
- 06. Malvern Road retail

ARTISTS IMPRESSION
COURTYARD - EVENING





Take a moment and you're taken to a world of restful peace. Inside personal space is grandly catered for, outside greenery and privacy offer perfect shelter. With living that flows effortlessly and thoughtful luxury, allow yourself to unwind.

ARTISTS IMPRESSION
BATHROOM - EVENING



A moment to unwind



Bathrooms boast double vanities set into marble. Main bathrooms feature bath and shower, en-suites fitted with shower. Premium fittings and mood lighting evoke comfort and calm.



ARTISTS IMPRESSION
EXTERIOR - EVENING

VIMG has selected the industry's leading proponents for this collaborative project.



VIMG is one of the most respected property developers in Sydney and Melbourne.

Over the past 10 years, VIMG has successfully invested and developed over half a billion dollars worth of iconic residential and mixed use properties.

VIMG's experience in managing whole of life property developments, and delivering cost-effective premium products to clients is a testimony to its capacity and market awareness.

vimg.com.au



Conrad Architects is a Melbourne-based Architectural and Interior Design practice specialising in the delivery of individually tailored design solutions to the highest quality.

The practice prides itself on its boutique nature, and philosophy of providing distinctive, elegant and timeless buildings. The enduring architectural principles of Space, Light and Proportion form the basis of all design work.

conradarchitects.com



Urban began as a collaboration between colleagues Bart O'Callahan and Tony Suttle and includes a hand-picked specialist team of property focused staff in Melbourne and Sydney.

Since 2009, the expert team at Urban has successfully developed and delivered more than \$2 billion worth of residential, commercial, retail, industrial and masterplanned projects.

Urban is trusted by leading financial institution and publicly listed real-estate businesses, with a reputation for bringing the very best service to clients.

urbandevelop.com.au



Marshall White Project's strength is in our professional team and unique processes provide the muscle to sell around Melbourne and the globe.

From pre-launch insights to innovative marketing events leading towards another successful sell-out, Marshall White Projects marketing perspective is thorough, hands on and intricately planned to provide you with the best results.

Marshall White Projects enjoy front of mind recognition and a well deserved trust from the buying public, providing our target audience with the comfort to proceed with a low-stress off the plan purchase, knowing they are in capable hands.

marshallwhiteprojects.com.au

scottgrovebyconrad.com.au

Design By Canyon

Any images, photographs and artist's impressions are for presentation purposes and indicative only.
They are also subject to change in accordance with the contract of sale. Final product may differ
from that described. Purchasers should check the plans and specifications included in the contract
of sale carefully prior to signing the contract of sale.